

VICINITY MAP AND SHEET LAYOUT

NTS

70 MERNDA VILLAGE DV  
ASSET PROVING  
MERNDA, VIC 3754

CLIENT:  
CITY OF WHITTLESEA

DATUM: MGA94 (ZONE55) & AHD

METHOD: TOTAL STATION WITH GNSS

NOTES: PLEASE SEE SHEET 2 'GENERAL NOTES' FOR TECHNICAL GUIDANCE  
AND AS5488.2 2019 LEGAL CAVEATS.  
SHEET 2 'GENERAL NOTES' LAST AMENDED 29-10-2019.  
ADD NOTE OR DELETE



WEB: [www.elsvic.com.au](http://www.elsvic.com.au)  
Phone: (03) 8795 7461  
Email: [projects@elsvic.com.au](mailto:projects@elsvic.com.au)

WARNING AND DISCLAIMER  
BEWARE OF UNDERGROUND SERVICES

The alignments of underground services plotted in these drawings are approximate only, located using radio detection methods. Accuracy of location & depth is only limited to the immediate area of a NDD proving or pit. Any additional depths indicated are electronic only and therefore should not be treated as accurate. It is the responsibility of the Contractor to prove the exact position and depth of a service on site, prior to works commencing. Furthermore, other services may exist, of which Environmental Location Systems are unaware. As such, the information provided herein should be verified by the relevant Service Authorities.

ELS PROJECT No. 4478-001



FIELDWORK: TF 19-11-2019  
SURVEYED: CC 19-11-2019

DBYD JOB NUMBER

18595747

No.	DATE	REVISION DESCRIPTION	DRAWN	QC'D	PROJECT MANAGER
A	19-11-2019	FOR CHECKING	SO	SM	RT



City of  
Whittlesea

ASSET PROVING – COVER SHEET  
70 MERNDA VILLAGE DV

CLIENT: CITY OF WHITTLESEA

SCALE: NTS SHEET NO: 1 OF 5

REV. A

1 : ELS ISSUED PLANS OR DIGITAL INFORMATION PERTAINING TO ASSET IDENTIFICATION AND LOCATION DOES NOT REPLACE DIAL BEFORE YOU DIG (DBYD) HISTORICAL DATA ISSUED BY AN ASSET OWNER. DUTY OF CARE, APPROVAL, PERMIT AND INSPECTION PROCESSES OF THE OWNER MUST BE SOUGHT AND ADHERED TO.

2 : THE DATE [FIELDWORK] PROVIDED ON EACH OF ELS DRAWINGS REPRESENTS THE LAST DAY AN ELS OPERATIVE WAS ON SITE TO LOCATE ASSETS. THE DATE [SURVEYED] REPRESENTS THE LAST DAY A SURVEYOR/TECHNICIAN ATTENDED THE SITE TO PERFORM FIELD OBSERVATIONS. ANY WORKS UNDERTAKEN AFTER THESE DATES CANNOT BE REPRESENTED BY ELS.

3 : DBYD RECORDS ARE USED FOR CREATING QL-C/D INFORMATION. ELS CANNOT INVESTIGATE INTERNAL PLANS, SITE LAYOUTS OR PROPOSED DESIGNS ON BEHALF OF ANY CLIENT. SHOULD YOU REQUEST US TO INCORPORATE PROPRIETARY INFORMATION REGARDING ASSETS, WE REQUIRE THAT, AS A MINIMUM, YOU PROVIDE AN ELECTRONIC COPY OF THE PROPOSED DRAWINGS VIA EMAIL, WITH THE UNDERSTANDING THAT THESE ARE USED VERBATIM AS PROVIDED TO US.

4 : ALL WORKS UNDERTAKEN BY ELS ADHERE TO AS-5488.2 2019. AS SUCH ALL ELECTRONIC LOCATING/SURVEYING IS ISSUED AS QL-B. ELS WILL ACCEPT NO RESPONSIBILITY FOR USE OF THIS LEVEL INFORMATION FOR DESIGN PURPOSES OR DURING CONSTRUCTION WHERE A HORIZONTAL ACCURACY GREATER THAN +/-300mm OR ELEVATION ACCURACY GREATER THAN +/-500mm IS REQUIRED. NONDESTRUCTIVE DIGGING (NDD) SHOULD BE UNDERTAKEN BY ANY CLIENT REQUIRING DATA FOR DESIGN PROCESSES OR TO PROVE TO AS-5488.2 2019 QL-A OF +/-50mm.

5 : ELS WILL ENDEAVOR TO PROVIDE OUR CLIENTS WITH THE MAXIMUM AMOUNT OF INFORMATION TO THE HIGHEST AS-5488.2 2019 QUALITY LEVEL. AS SUCH OUR LINE STRINGS WILL REPRESENT THE MAXIMUM EXTENSION BETWEEN POINTS, DIRECTLY OBSERVED ON SITE, WHERE WE BELIEVE THE HIGHEST QUALITY LEVEL CAN BE INFERRED TO.

6 : DUE TO THE NATURE OF UNDERGROUND ASSETS AND HISTORICAL RECORD RETRIEVAL IT IS POSSIBLE THAT BETWEEN ANY FIELD OBSERVATION LOCATIONS A SERVICE MAY DEViate FROM THAT DESCRIBED IN OUR DRAWINGS/ELECTRONIC DATA. ELS MAKES EVERY EFFORT TO REDUCE THE RISK TO OUR CLIENTS, BUT WE CANNOT GUARANTEE WORKS OUTSIDE OF AS-5488.2 2019 FRAMEWORK AND CANNOT GUARANTEE QL-A ACCURACY DATA AT ANY OTHER POINT THAN THAT DIRECTLY OBSERVED/RECORDED.

7 : NDD WORKS UNDERTAKEN TO IDENTIFY AND RECORD QL-A DATA RELY ON HISTORICAL AND ARCHIVED DATA BOTH FROM OUR CLIENTS AND THE RELEVANT ASSET OWNERS DATABASE(S), PROVIDED THROUGH THE DBYD AUTHORITY. ELS CANNOT GUARANTEE THE VERACITY OF ANY QL-C/D INFORMATION RETRIEVED IN SUCH A WAY AND WHILE WE ENDEAVOR TO ISOLATE THE CORRECT SERVICES THE NATURE OF THE DBYD SERVICE IS SUCH THAT WE CANNOT GUARANTEE AGAINST MISIDENTIFICATION OF ASSETS IN THE GROUND. WE WOULD SUGGEST A NOTIFICATION TO ANY ASSET OWNERS IN THE AREA OF WORKS PRIOR TO ANY EXCAVATION/PENETRATION.

8 : SEVERAL ASSET OWNERS ISSUE ONLY SCHEMATIC OR INDICATIVE INFORMATION VIA DBYD. WHEN REPRESENTING THIS INFORMATION, OR INDEED ANY QL-C/D INFORMATION, ELS ISSUES IT ONLY AS INDICATIVE AND CANNOT GUARANTEE ANYTHING INFERRED FROM THIS DATA.

9 : ELS WILL, WHERE POSSIBLE, KEEP TO THE INDUSTRY RECOGNISED COLOURING AND SYSTEM FOR ASSETS, AS USED BY THEIR OWNERS. A FULL LEGEND OF ELS LINETYPES AND THEIR NOMINATIONS ARE AVAILABLE ON ALL ELS "PLAN" DRAWING SHEETS FOR REFERENCE.

10: DOMESTIC, PRIVATE OR PROPERTY CONNECTIONS (LEAD-INS)WOULD NOT, IN THE NORMAL COURSE OF EVENTS, BE LOCATED INDIVIDUALLY FOR EACH PROPERTY AS THEY DO NOT ALWAYS APPEAR ON THE HISTORICAL DATA, ELS CAN UNDERTAKE WORKS TO IDENTIFY THESE CONNECTIONS BASED ON BEST PRACTICE, EXPERIENCE AND ASSET FEATURE LOCATION IN THE FIELD. HOWEVER, WE WILL ONLY DO SO UNDER THE DIRECTION OF OUR CLIENT AND HOLD NO RESPONSIBILITY FOR ANY ADDITIONAL COSTS INCURRED TO THE CLIENT IF EXTENSIVE INVESTIGATIVE WORK NEEDS TO BE UNDERTAKEN.

11 : ELS INVESTS HEAVILY IN TRAINING AND PROFESSIONAL DEVELOPMENT OF OUR FIELD STAFF. AS SUCH, LOCATION OPERATIVES WILL EITHER BE DBYD ACCREDITED OR UNDER THE DIRECT SUPERVISION OF AN ACCREDITED, SUITABLY EXPERIENCED INDIVIDUAL.

12 : ELS WILL ENDEAVOR TO IDENTIFY AND ISOLATE ASSETS DESCRIBED IN OUR CLIENTS SCOPES AND AS SUCH MAY IDENTIFY ADDITIONAL ASSETS WITHIN THE 'SCOPE AREA'. WE CANNOT GUARANTEE THAT WE HAVE "IDENTIFIED ALL ASSETS" IN ANY PARTICULAR AREA AND WORK UNDER THE INSTRUCTION OF OUR CLIENTS AND WITHIN THE FRAMEWORK OF THE DBYD SYSTEM.

13 : ASSETS PRESENT THAT HAVE NOT BEEN NOMINATED BY THE CLIENT AS A PARTICULAR ENTITY E.G. "LIGHTNING PROTECTION" OR "CLUB HOUSE SUPPLY" WILL BE NOMINATED ONSITE BY OUR FIELD OPERATIVES AS THE CLOSEST GENERIC TYPE, E.G. "DIRECT BURIED LV" OR "50ø PVC LV".

14 : SERVICE LOCATE/SURVEY INFORMATION WILL BE PRESENTED IN THE CLEAREST MANNER POSSIBLE. WE PRESENT OUR DIAMETER, MATERIAL AND 'END OF LINE' CALLOUTS AT EITHER THE END OF THE STRINGS REPRESENTING OUR FIELD OBSERVATIONS OR AT THE LOCATIONS OF THE ACCESS PITS I.E. THE START/FINISH OF ANY LINE. IN AN INSTANCE WHERE A LINE PRESENTS NO TERMINATION IN THE DRAWING SHEET AN ADDITIONAL CALLOUT WILL BE ADDED FOR EACH SHEET ON WHICH THIS OCCURS, ALLOWING IDENTIFICATION AT ALL TIMES.

15 : WHERE WE HAVE UTILISED GPR TO LOCATE ASSETS THE DRAWING CALL-OUTS FOR THESE LOCATIONS WILL BE NOTED AS "GPR LOCATED". WHERE WE ARE CONFIDENT OF THE RESULTS COMPLYING TO QL-B STANDARDS WE WILL RETAIN A QL-B LINETYPE. IN THE CASE OF ASSETS DEEPER THAN APPX. 1.2m OR WHERE WE ARE NOT CONFIDENT IN THE RETURN SIGNAL WE WILL NOTE FURTHER DETAILS IN THE CALL-OUT OR REPLACE THE REPRESENTATIVE LINE WITH A QL-C/D LINE. THIS SHOULD INFORM THE VIEWER THAT THE DATA COMPLIES WITH THE RELEVANT QUALITY LEVEL ASSURANCES AS PER ASS488.2 2019.

16 : WHERE PITS ARE ABLE TO BE OPENED,OR THE ASSET HAS BEEN PHYSICALLY VIEWED IN THE FIELD, ANY SIZE/MATERIAL AND PHYSICAL DEPTH CAN BE CHECKED AND REPORTED AS OBSERVED, REGARDLESS OF ANY CONFLICTING DBYD INFORMATION OR CLIENT SUPPLIED DOCUMENTS. WHERE PITS ARE UNABLE TO BE LIFTED OR AN ASSET CANNOT BE ACCESSED ELS WILL ISSUE INFORMATION INCORPORATING DIAMETERS, NUMBER OF, CONFIGURATION AND MATERIAL TYPES AS DESCRIBED ON THE RETRIEVED DBYD RECORDS.

17 : WHERE ELS HAS PERFORMED QL-B INVESTIGATION ON PIPES OVER 450ø USING A METHOD OF "RODDING" I.E. PASSING A FLEXIBLE ROD CARRYING AN ELECTRONIC SIGNAL THROUGH THE PIPE, WE CAN ONLY RETURN AN INDICATIVE RESULT FOR THIS ASSET. THE PRACTICAL LIMITATIONS ARE THAT THE FLEXIBLE ROD MAY BE LOCATED ANYWHERE WITHIN THE BORE OF THE PIPE. THIS WOULD, IN GENERAL, BE OF GREATEST RELEVANCE FOR STORMWATER AND SEWER ASSETS. WHERE 'AIR-LOCKS' OR OTHER DEVIATIONS ARE REQUIRED TO BE INVESTIGATED, ONLY QL-A INVESTIGATIONS WILL RETURN AN ACCEPTABLE RESULT.

18 : FIELD OBSERVATIONS FOR BOTH LOCATING AND NDD WORKS WILL BE REPRESENTED AS DISTINCT LINES REGARDLESS OF THEIR PROXIMITY TO EACH OTHER. IT IS NOT ALWAYS POSSIBLE TO ISOLATE ADJACENT ASSETS, DUE TO THE NATURE OF ELECTRONIC LOCATING PRACTICES. WHERE MULTIPLE ADJACENT ASSETS ARE NOT IDENTIFIED INDIVIDUALLY ELS WILL PROVIDE CALLOUT INFORMATION DESCRIBING THE NUMBER OF ASSETS REPRESENTED BY THE LINES IN THE DRAWING E.G. 4x100ø PVC. WHERE HISTORICAL INFORMATION REPRESENTS SEVERAL SIMILAR ASSETS ADJACENT TO EACH OTHER AND FOLLOWING THE SAME ROUTE, THEY MAY BE REPRESENTED AS A SINGLE LINE FOR CLARITY.

19 : WE UNDERTAKE TO PROVIDE OUR CLIENTS WITH AS MUCH RELEVANT INFORMATION AS POSSIBLE, HOWEVER, WE WILL ONLY PROJECT OUR HISTORICAL SEARCHES TO INCORPORATE ANY SCOPE AREA PROVIDED TO US AND EXTEND THIS TO THE AREA REPRESENTED BY OUR DRAWINGS. ASSETS PRESENT OUTSIDE THIS AREA WILL NOT BE INVESTIGATED BY US UNLESS THEY PRESENT INFORMATION REQUIRED FOR ASSUMING ALIGNMENTS OR AID IN THE ISOLATION OF THE REQUIRED ASSETS FROM OUR CLIENTS.

20 : WHERE WE ARE REQUIRED TO REVISIT A SITE FOR ONGOING WORKS, EITHER AS AN EXTENSION OF A PREVIOUSLY DESCRIBED PROJECT ENGAGEMENT OR UNDER AN HOURLY CONTRACT, DRAWINGS WILL BE ISSUED AS [NUMBER]-001, [NUMBER]-002 AND HISTORICAL ELECTRONIC DATA WILL BE PREFIXED WITH THE RELEVANT DRAWING NUMBERS, OR PREVIOUS ISSUED INFORMATION DATE AS ALWAYS ELS WILL ONLY ISSUE THE INFORMATION FOR USE WITHIN 28 DAYS, SO THE ACCURACY OF HISTORICAL DATA ISSUED THIS WAY IS WHOLLY DEPENDANT ON THE CLIENTS KNOWLEDGE OF WORKS IN THE AREA.

21 : ELS PERFORMS ALL OF IT'S SURVEY FIELDWORKS IN MGA94 UTILISING THE AHD PERMANENT MARK NETWORK TO MAINTAIN A STANDARD REDUCED LEVEL. ALL EFFORTS WILL BE MADE TO IDENTIFY AND OBSERVE THE CLOSEST PERMANENT MARK TO THE CLIENT SUPPLIED SCOPE AREA, PROVIDED BY THE SMES SYSTEM, THAT HAS BEEN ALLOCATED A VERTICAL TOLERANCE OF LESS THAN 100mm, WHERE PRACTICABLE.

22 : WHERE WE ARE PROVIDED CAD DATA BY THE CLIENT FOR USE IN THE DELIVERABLE WE ACCEPT NO RESPONSIBILITY FOR THE ACCURACY OF THAT INFORMATION. IF THE CLIENT REQUIRES ELS TO TRANSFORM OUR DATA FROM MGA94 ONTO A "LOCAL" CO-ORDINATE SYSTEM WE CAN NO LONGER FULLY GUARANTEE THE ACCURACY OF THE INFORMATION AS ANY MATHEMATICAL TREATMENT OF THE FIELD OBSERVATIONS BECOMES WHOLLY RELIANT ON THE INFORMATION PROVIDED TO US, OF WHICH WE HAVE NO CONTROL.

LINE/ASSET ABBREVIATIONS :

- LV – LOW VOLTAGE ELECTRICAL
- HV – HIGH VOLTAGE ELECTRICAL
- PL – PUBLIC LIGHTING
- VT – VICTRACK
- T – TELECOMMS/TELSTRA
- COMMS – COMMUNICATIONS
- FO – FIBRE OPTIC
- G\_LP – LOW PRESSURE GAS
- G\_HP – HIGH PRESSURE GAS
- TP\_GAS – TRANSMISSION PIPELINE (GAS)
- WAG – WESTERN PORT ALTONA GEELONG
- W – WATER (POTABLE)
- RW – RECYCLED WATER
- GW – GREYWATER
- SW – STORMWATER
- S – SEWER
- ? – UNKNOWN

23 : FOR LOCATE/SURVEY WORKS UNDERTAKEN BY ELS AND REQUESTED TO BE PUT "IN LOCAL", THE SCALAR ADJUSTMENT FROM MGA REPRESENTS A MINIMAL ERROR AND SHOULD BE ABLE TO ABSORB ANY TRUE METER DIMENSION CHANGES WHILST STILL ADHERING TO AS-5488 QL-B STANDARDS. IF CLIENT SUPPLIED TBM DATA DEVIATES FROM THE EXPECTED SCALAR ADJUSTMENT FOR THE SITE LOCALITY, ELS WILL EITHER RETURN THE DELIVERABLE IN MGA94, OR ALTERNATIVELY, ALTER THE RESULTS TO SUIT THE CLIENT SUPPLIED DATA, BUT WE WILL NOT GUARANTEE THE DATA WILL ADHERE TO AS-5488 TOLERANCES.

24 : FOR JOBS OF A LINEAR METERAGE GREATER THAN 1KM, WE CANNOT GUARANTEE THE ACCURACY OF THE EXTREMITIES UNLESS WE ARE PROVIDED A "CENTROID" FOR THE SCALAR CONVERSION BY THE CLIENT.

25 : FOR NDD WORKS UNDERTAKEN BY ELS AND REQUESTED TO BE PUT "IN LOCAL" ELS WILL NOT GUARANTEE ANY OF THE WORKS ADHERE TO AS-5488.2 2019 QL-A STANDARDS IN THE NEW CO-ORDINATE SYSTEM. WE WILL ONLY STATE THAT THE RESULTS ARE CORRECT TO THE REFERENCE POINTS PROVIDED BY THE CLIENT. ON REQUEST ELS CAN PROVIDE THE ORIGINAL MGA94 CO-ORDINATED FIELD INFORMATION.

26 : WHERE CAD INFORMATION HAS BEEN PROVIDED TO ELS BY A CLIENT AFTER A QUOTE HAS BEEN ACCEPTED AND TRANSFORMATIONS ARE REQUIRED, ADDITIONAL CHARGES MAY BE INCURRED BY THE CLIENT FOR SURVEY/DRAFTING RESOURCES TO BE ALLOCATED FOR THE NECESSARY MATHEMATICAL TREATMENTS.

27 : UNDER INSTRUCTION ELS WILL ADOPT CLIENT PROVIDED TBMS FOR REDUCING LEVELS, AS OPPOSED TO UTILISING THE AHD NETWORK. IN THE ABSENCE OF ANY DIRECTION FROM THE CLIENT ELS WILL NOMINATE ONE OF THE PROVIDED TBMS AND RETURN RESULTS IN RELATION TO THIS SINGLE POINT. ELS WILL NOT UNDERTAKE INVESTIGATIVE WORKS TO PROVE THE INTERNAL ACCURACY OF ANY CLIENT SUPPLIED CONTROL NETWORKS, ANY INFORMATION PERTAINING TO SURVEY CONTROL WILL BE USED VERBATIM AS PROVIDED TO US.

28 : AS PART OF OUR STANDARD DELIVERABLE ELS INCLUDE NEARMAP AERIAL IMAGERY AND CADASTRAL BOUNDARIES PROVIDED BY THE VICTORIAN GOVERNMENT. ELS ENDEAVOR TO INCLUDE THE MOST UP TO DATE INFORMATION AVAILABLE REGARDING CADASTRAL BOUNDARY INFORMATION BUT ACCEPT NO RESPONSIBILITY FOR THE DATA INCLUDED IN THE DRAWING AS IT IS PROVIDED TO US, GRATIS, VIA THE SERVICE AVAILABLE AT [ <http://services.land.vic.gov.au/SpatialDatamart/> ]. WE RETAIN ALL FORMAT AND LAYER DEFINITIONS FROM THE PROVIDER.

COMMON PIPE/CONDUIT MATERIAL ABBREVIATIONS :

- PVC – POLYVINYL CHLORIDE
- PP – POLYPROPYLENE
- VC – VITREOUS CLAY
- AC – ASBESTOS CEMENT
- RCP – REINFORCED CONCRETE PIPE
- E – EARTHENWARE
- CICL – CAST IRON CEMENT LINED
- DICL – DUCTILE IRON CEMENT LINED
- MSCL – MILD STEEL CEMENT LINED
- GI – GALVANISED IRON
- CONC. – CONCRETE
- S – STEEL
- P – PLASTIC (GAS, USUALLY PE)

QUALITY LEVEL	DESCRIPTION	METHOD	TOLERANCES		RISK
QL-C/D	INDICATIVE/SCHEMATIC	ANY/ALL HISTORICAL DATA AVAILABLE. PRIMARILY DBYD RECORDS BUT MAY INCLUDE CLIENT SUPPLIED AND SURFACE FEATURE DATA.	HORIZONTAL	N/A	
			VERTICAL	N/A	
QL-B	3D INFORMATION RELATIVE TO AN EXISTING SURFACE	GPR AND ELECTRONIC LOCATION METHODS AND GPS/TOTAL STATION SURVEY.	HORIZONTAL	+/- 300mm	
			VERTICAL	+/- 500mm	
QL-A	PRECISE 3D INFORMATION FOR AN EXPOSED ASSET	NDD EXPOSURE OF ASSETS AND GPS/TOTAL STATION SURVEY CHECKED USING PHYSICAL AND LEVELING PROCESSES.	HORIZONTAL	+/- 50mm	
			VERTICAL	+/- 50mm	

NDD QL-A POTHOLE CALLOUT STRUCTURE

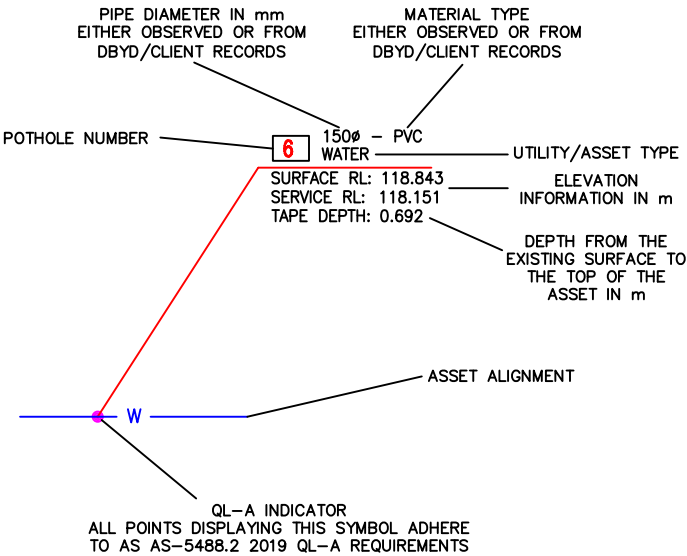

ELS STANDARD CALLOUT STRUCTURE

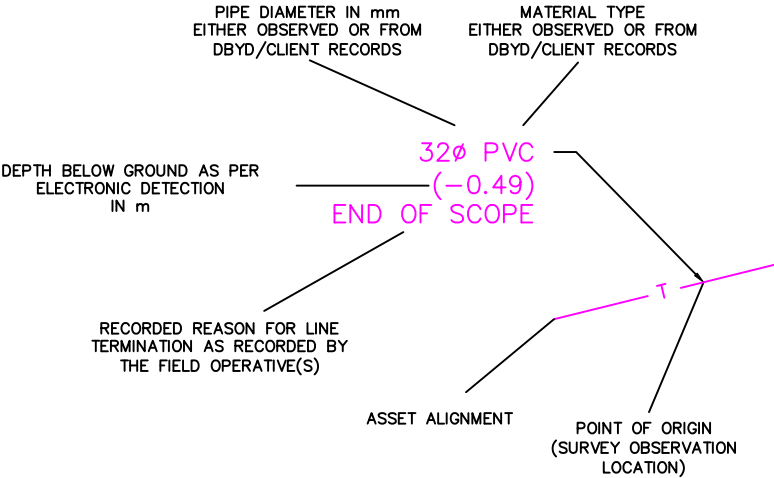

AS-5488.2 2019 QUALITY LEVELS AS THEY PERTAIN TO ELS ISSUED INFORMATION



WEB: [www.elsvic.com.au](http://www.elsvic.com.au)  
Phone: (03) 8795 7461  
Email: [projects@elsvic.com.au](mailto:projects@elsvic.com.au)

WARNING AND DISCLAIMER  
BEWARE OF UNDERGROUND SERVICES

The alignments of underground services plotted in these drawings are approximate only, located using radio detection methods. Accuracy of location & depth is only limited to the immediate area of a NDD proving or pit. Any additional depths indicated are electronic only and therefore should not be treated as accurate. It is the responsibility of the Contractor to prove the exact position and depth of a service on site, prior to works commencing. Furthermore, other services may exist, of which Environmental Location Systems are unaware. As such, the information provided hereon should be verified by the relevant Service Authorities.



ELS PROJECT No. 4478-001

FIELDWORK: TF 19-11-2019  
SURVEYED: CC 19-11-2019

A	19-11-2019	FOR CHECKING	SO	SM	RT
No.	DATE	REVISION DESCRIPTION	DRAWN	QC'D	PROJECT MANAGER

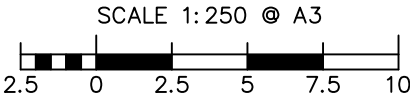

CLIENT: CITY OF WHITTLESEA

GENERAL NOTES

SCALE: NTS SHEET NO: 2 OF 5 REV. A



70 MERNDA VILLAGE DV					CLIENT	CITY OF WHITTLESEA
					PROJECT	70 MERNDA VILLAGE DV ASSET PROVING MERNDA, VIC 3754
NO.	SERVICE TYPE	SURFACE LOCATION		TAPE DEPTH	TOP OF SERVICE RL	NOTES
1	3x100ø-PVC TELSTRA	X: 331452.750 Y: 5837599.106	Z: 173.469	1.025	172.444	-
2	100ø & 125ø-PVC ELEC-HV	X: 331452.902 Y: 5837598.999	Z: 173.478	1.099	172.379	-
3	2x100ø-PVC OPTIC FIBER	X: 331453.126 Y: 5837598.931	Z: 173.481	1.106	172.375	-
4	900ø-RCP DRAINAGE	X: 331454.308 Y: 5837598.216	Z: 173.481	1.282	172.199	-
5	900ø-RCP DRAINAGE	X: 331461.942 Y: 5837611.277	Z: 173.438	1.295	172.143	-
6	63ø-PVC ELEC-LV	X: 331461.847 Y: 5837611.093	Z: 173.442	0.843	172.599	-
7	2x100ø-PVC OPTIC FIBER	X: 331460.396 Y: 5837611.022	Z: 173.428	1.095	172.333	-
8	125ø-PVC ELEC-HV	X: 331460.266 Y: 5837611.096	Z: 173.435	1.056	172.379	-
9	100ø-PVC ELEC-LV	X: 331460.166 Y: 5837611.252	Z: 173.428	1.029	172.399	-
10	3x100ø-PVC TELSTRA	X: 331459.792 Y: 5837611.439	Z: 173.428	0.775	172.653	-
11	COVERSLAB GAS-HP	X: 331474.885 Y: 5837599.541	Z: 173.575	-	-	DEPTH TO COVER SLAB - 0.977m
12	225ø-MPVC WATER	X: 331474.030 Y: 5837599.179	Z: 173.550	0.857	172.693	-
13	NO PROVING CONCRETE OBSTRUCTION	X: 331473.877 Y: 5837599.892	Z: -	-	-	-
14	225ø-MPVC WATER	X: 331468.632 Y: 5837589.772	Z: 173.554	0.880	172.674	-
15	COVER SLAB GAS-HP	X: 331469.160 Y: 5837589.448	Z: 173.572	-	-	DPETH TO COVER SLAB - 0.97m



WEB: [www.elsvic.com.au](http://www.elsvic.com.au)  
Phone: (03) 8795 7461  
Email: [projects@elsvic.com.au](mailto:projects@elsvic.com.au)

**WARNING AND DISCLAIMER  
BEWARE OF UNDERGROUND SERVICES**

The alignments of underground services plotted in these drawings are approximate only, located using radio detection methods. Accuracy of location & depth is only limited to the immediate area of a NDD proving or pit. Any additional depths indicated are electronic only and therefore should not be treated as accurate. It is the responsibility of the Contractor to prove the exact position and depth of a service on site, prior to works commencing. Furthermore, other services may exist, of which Environmental Location Systems are unaware. As such, the information provided hereon should be verified by the relevant Service Authorities.



ELS PROJECT No. 4478-001

FIELDWORK: TF 19-11-2019  
SURVEYED: CC 19-11-2019

A	19-11-2019	FOR CHECKING	SO	SM	RT
No.	DATE	REVISION DESCRIPTION	DRAWN	QC'D	PROJECT MANAGER



**City of Whittlesea**

CITY OF WHITTLESEA

ASSET PROVING -DEPTHING TABLE  
70 MERNDA VILLAGE DV

SCALE: NTS SHEET NO: 3 OF 5 REV. A



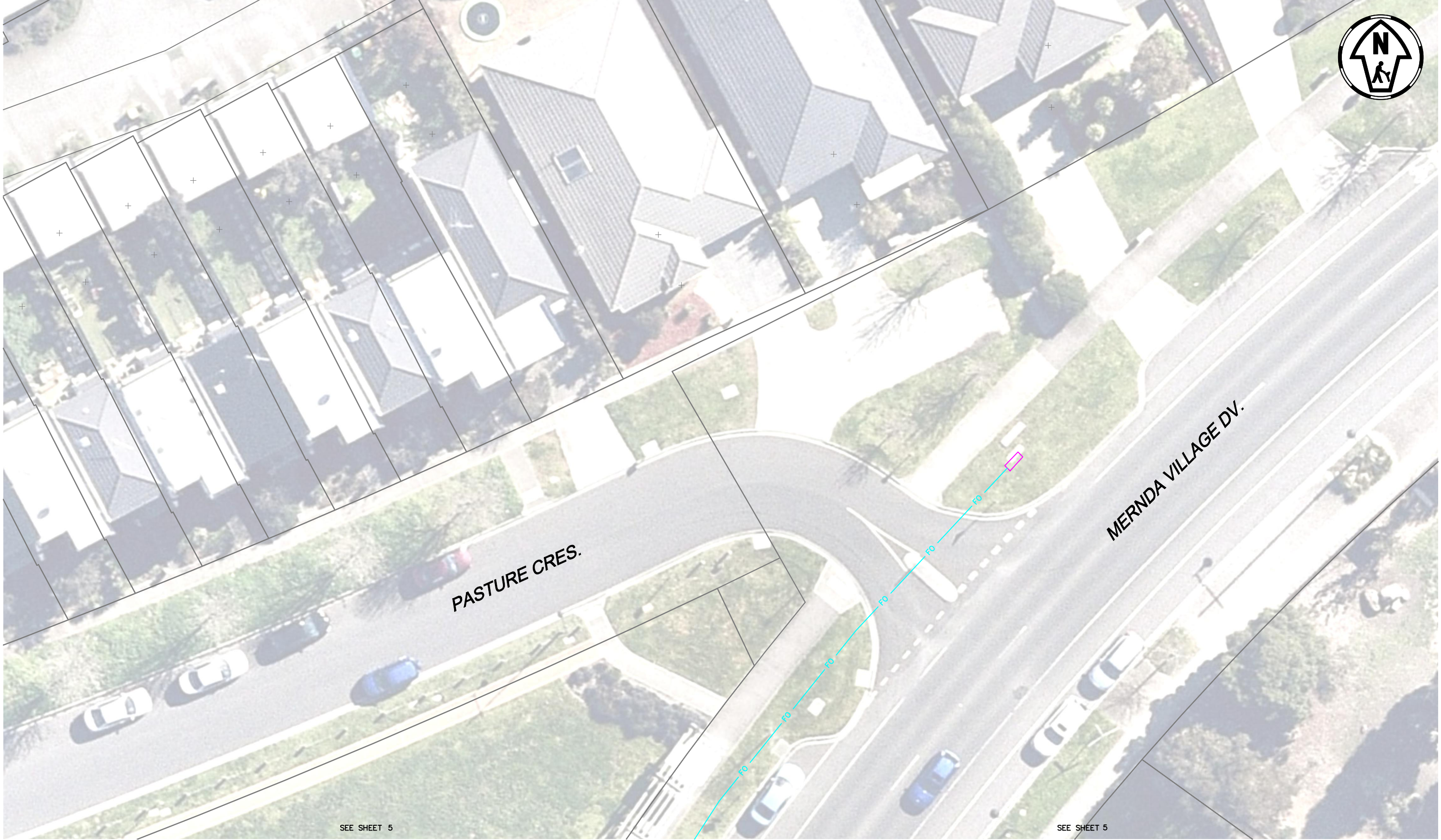

LINETYPES (QL-B)

LV	ELEC LOW VOLTAGE	VT COMM	VICTRACK [ASSET]	WAG	WAG PIPE LINE	W	WATER
HV	ELEC HIGH VOLTAGE	FO	FIBRE OPTICS	OIL	OIL TRANSMISSION	W	ABANDONED WATER
PL	ELEC PUBLIC LIGHTING	TPG	FIBRE DISPLAYING OWNER	LV OH	LV OVERHEAD	W	IRRIGATION WATER
VT 2.2KV	2.2KV CABLES (VICTRACK)	NBN	NBN	HV OH	HV OVERHEAD	W	RECYCLED WATER
T	TELECOM	O2	GAS WITH TYPE [OXYGEN]	T OH	TELECOM OVERHEAD	W	GREY WATER
OPTUS	TELECOM DISPLAYING OWNER	G LP	GAS DISPLAYING PRESSURE	SW	STORM WATER	W	FIRE SERVICE
COMMS	COMMUNICATIONS	GAS ISO	ISOLATED GAS MAIN	S	SEWER	W	UNKNOWN SERVICE

--- G HP ---	DOTTED LINES REPRESENT
--- G LP ---	QL-C OR QL-D LEVEL
--- W ---	DATA (DBYD OR HISTORICAL)
--- S ---	
--- SW ---	
--- T ---	
--- LV ---	

SYMBOLS

LP	LIGHT POLE	MSP	MAIN SWITCH BOARD	TAP	WATER TAP	SW	STORM WATER LID ROUND
PP	POWER POLE	DP	DEPTHING POINT (QL-A)	WV	WATER VALVE	OP	STORM WATER DOWN PIPE
TS	TRAFFIC SIGNAL	GV	GAS VALVE	WM	WATER METER	S	SEWER PIT ROUND
LV	LOW VOLTAGE MARKER	BH	BORE HOLE	FH	FIRE HYDRANT	IS	SEWER PIT SQUARE
EP	ELECTRICAL PIT	APA	ASSET MARKER POST SHOWING OWNER	SW	STORM WATER LID SQUARE	IO	INSPECTION OPENING
TP	TELECOMMS POLE			GR	GRATED STORM WATER PIT	BT	BOUNDARY TRAP

ABBREVIATIONS

AC	ASBESTOS CONCRETE	P	PLASTIC
BL	BUILDING LINE	PE	POLYETHYLENE
CI	CAST IRON	PP	POLYPROPYLENE
CICL	CAST IRON CEMENT LINED	PVC	POLYVINYL CHLORIDE (PLASTIC)
CU	COPPER	RCP	REINFORCED CONCRETE PIPE
DICL	DUCTILE IRON CEMENT LINED	S	STEEL
E	EARTHENWARE/TERRACOTA	UPVC	UNKNOWN
GI	GALVANIZED IRON	VC	UNPLASTICIZED PVC
INV.	INVERT		VITRIFIED CLAY
IO	INSPECTION OPENING		
MSCL	MILD STEEL CEMENT LINED		



WEB: [www.elsvc.com.au](http://www.elsvc.com.au)  
Phone: (03) 8795 7461  
Email: [projects@elsvc.com.au](mailto:projects@elsvc.com.au)

**WARNING AND DISCLAIMER**  
**BEWARE OF UNDERGROUND SERVICES**  
The alignments of underground services plotted in these drawings are approximate only, located using radio detection methods. Accuracy of location & depth is only limited to the immediate area of a NDD proving or pit. Any additional depths indicated are electronic only and therefore should not be treated as accurate. It is the responsibility of the Contractor to prove the exact position and depth of a service on site, prior to works commencing. Furthermore, other services may exist, of which Environmental Location Systems are unaware. As such, the information provided hereon should be verified by the relevant Service Authorities.

**ELECTRONIC DEPTH ONLY**  
QUALITY LEVEL B TO AS-5488.2 2019  
CONTRACTOR TO VERIFY LOCATION & DEPTH OF SERVICES PRIOR TO WORKS COMMENCING



ELS PROJECT No. 4478-001

FIELDWORK: TF 19-11-2019  
SURVEYED: CC 19-11-2019

No.	DATE	REVISION DESCRIPTION	DRAWN	QC'D	PROJECT MANAGER
A	19-11-2019	FOR CHECKING	SO	SM	RT

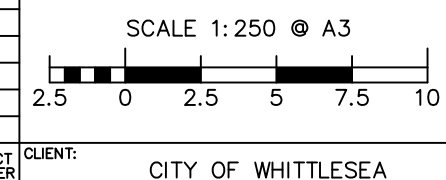

ASSET PROVING - PLAN 70 MERNDA VILLAGE DV			
SCALE: 1:250	SHEET NO: 4 OF 5	REV. A	



SEE SHEET 4

SEE SHEET 4

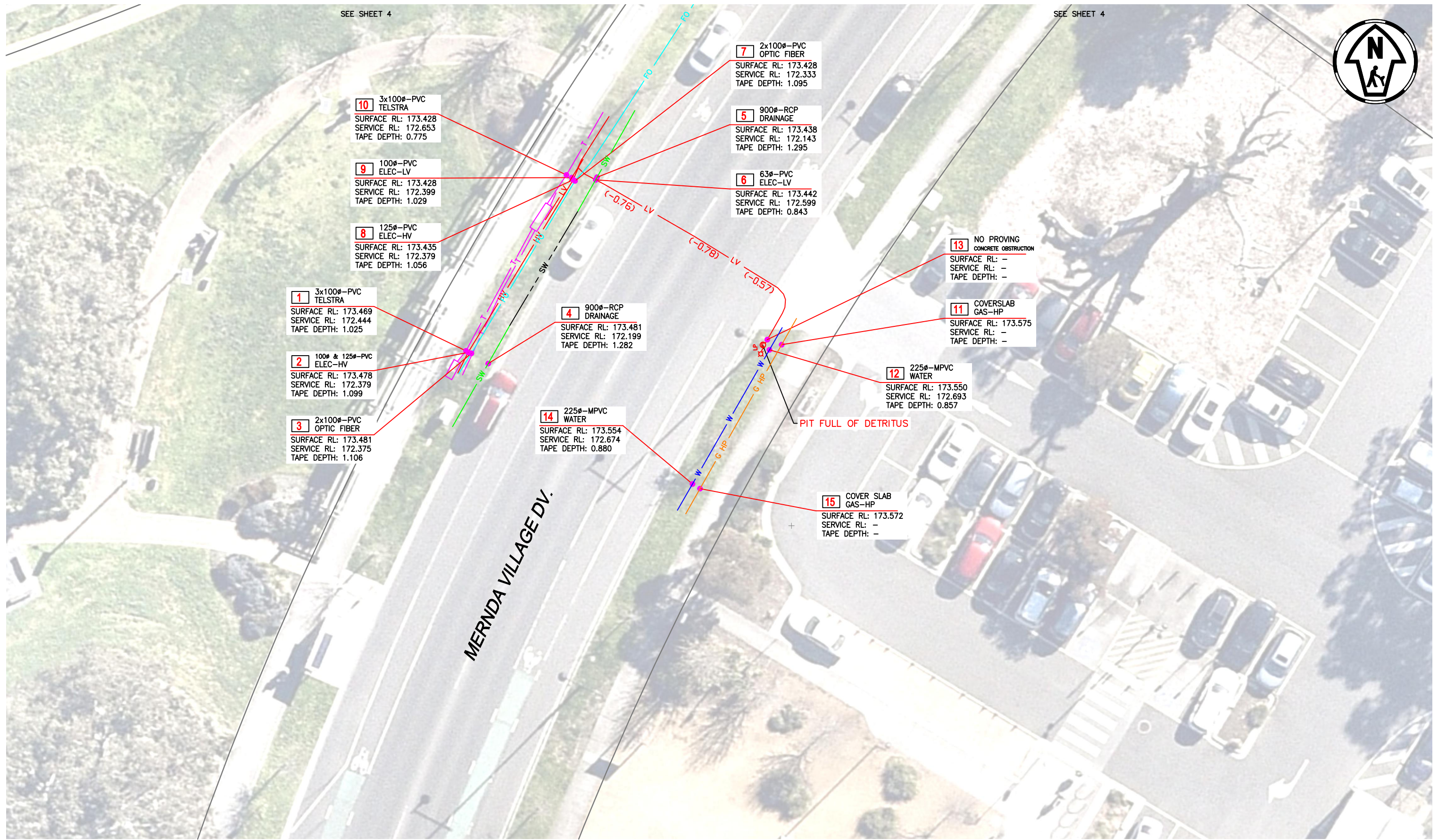

LINETYPES (QL-B)

LV	ELEC LOW VOLTAGE	VT COMM	VICTRACK [ASSET]	WAG	WAG PIPE LINE	W	WATER	---	G HP	DOTTED LINES REPRESENT
HV	ELEC HIGH VOLTAGE	FO	FIBRE OPTICS	OIL	ABANDONED WATER	W	ABANDONED WATER	---	G LP	QL-C OR QL-D LEVEL
PL	ELEC PUBLIC LIGHTING	TPG	FIBRE DISPLAYING OWNER	LV OH	OIL TRANSMISSION	W	IRRIGATION WATER	---	W	DATA (DBYD OR HISTORICAL)
VT 2.2KV	2.2KV CABLES (VICTRACK)	NBN	NBN	HV OH	LV OVERHEAD	W	RECYCLED WATER	---	S	
T	TELECOM	O2	GAS WITH TYPE [OXYGEN]	T OH	HV OVERHEAD	W	GREY WATER	---	SW	
OPTUS	TELECOM DISPLAYING OWNER	G LP	GAS DISPLAYING PRESSURE	SW	TELECOM OVERHEAD	W	FIRE SERVICE	---	T	
COMMS	COMMUNICATIONS	GAS ISO	ISOLATED GAS MAIN	S	STORM WATER	W	UNKNOWN SERVICE	---	LV	

---	G HP	DOTTED LINES REPRESENT
---	G LP	QL-C OR QL-D LEVEL
---	W	DATA (DBYD OR HISTORICAL)
---	S	
---	SW	
---	T	
---	LV	

SYMBOLS

LP	LIGHT POLE	MSP	MAIN SWITCH BOARD	WAP	WATER TAP	SW	STORM WATER LID ROUND
PP	POWER POLE	DP	DEPTHING POINT (QL-A)	WV	WATER VALVE	SD	STORM WATER DOWN PIPE
TS	TRAFFIC SIGNAL	GV	GAS VALVE	WM	WATER METER	S	SEWER PIT ROUND
LV	LOW VOLTAGE MARKER	BH	BORE HOLE	FH	FIRE HYDRANT	S	SEWER PIT SQUARE
EP	ELECTRICAL PIT	APA	ASSET MARKER POST SHOWING OWNER	SW	STORM WATER LID SQUARE	IO	INSPECTION OPENING
TP	TELECOMMS POLE			STW	GRATED STORM WATER PIT	BT	BOUNDARY TRAP

ABBREVIATIONS

AC	ASBESTOS CONCRETE	P	PLASTIC
BL	BUILDING LINE	PE	POLYETHYLENE
CI	CAST IRON	PP	POLYPROPYLENE
CIL	CAST IRON CEMENT LINED	PVC	POLYVINYL CHLORIDE (PLASTIC)
CU	COPPER	RCP	REINFORCED CONCRETE PIPE
DICL	DUCTILE IRON CEMENT LINED	S	STEEL
E	EARTHENWARE/TERRACOTA	UPVC	UNPLASTICIZED PVC
GI	GALVANIZED IRON	VC	VITRIFIED CLAY
INV.	INVERT		
IO	INSPECTION OPENING		
MSCL	MILD STEEL CEMENT LINED		



**WARNING AND DISCLAIMER**  
**BEWARE OF UNDERGROUND SERVICES**  
The alignments of underground services plotted in these drawings are approximate only, located using radio detection methods. Accuracy of location & depth is only limited to the immediate area of a NDD proving or pit. Any additional depths indicated are electronic only and therefore should not be treated as accurate. It is the responsibility of the Contractor to prove the exact position and depth of a service on site, prior to works commencing. Furthermore, other services may exist, of which Environmental Location Systems are unaware. As such, the information provided hereon should be verified by the relevant Service Authorities.

**ELECTRONIC DEPTH ONLY**  
QUALITY LEVEL B TO AS-4489.2 2019  
CONTRACTOR TO VERIFY LOCATION & DEPTH OF SERVICES PRIOR TO WORKS COMMENCING



WEB: [www.elsvc.com.au](http://www.elsvc.com.au)  
Phone: (03) 8795 7461  
Email: [projects@elsvc.com.au](mailto:projects@elsvc.com.au)

ELS PROJECT No. 4478-001

FIELDWORK: TF 19-11-2019  
SURVEYED: CC 19-11-2019

No.	DATE	REVISION DESCRIPTION	DRAWN	QC'D	PROJECT MANAGER
A	19-11-2019	FOR CHECKING	SO	SM	RT

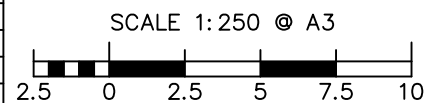

CITY OF WHITTLESEA

ASSET PROVING - PLAN  
70 MERNDA VILLAGE DV

SCALE: 1:250 SHEET NO: 5 OF 5 REV. A